

HUSSMANN®

D5XRRI, D5XRRIS

IMPACT EXCEL

Rear Roll-In Dairy Merchandiser



Rear Roll-In Dairy Merchandiser

Models Available

D5XRRRI-Rear roll-in dairy merchandiser

D5XRRIS-Rear roll-in dairy merchandiser, suspended canopy

Available in 6', 8' & 12' lengths.



D5XRRRI

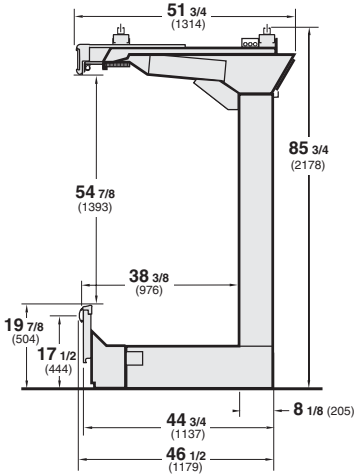

D5XRRIS

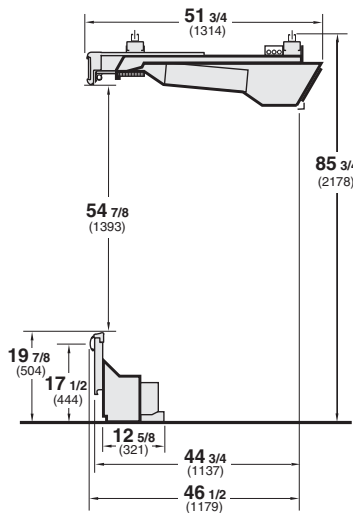

D5XRRRI, D5XRRIS Plan View

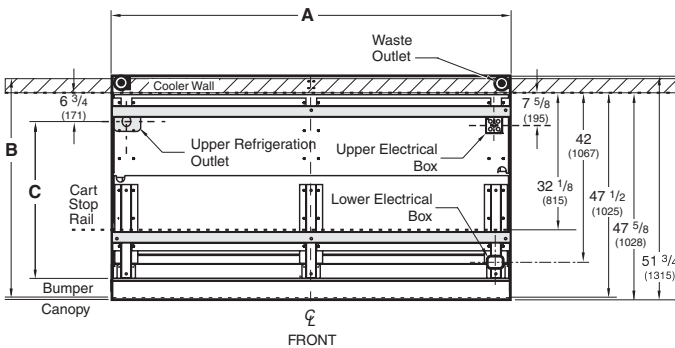

Dimension	A	B	C
6 foot	72 3/8 (1838)	51 3/4 (1314)	44 (1117)
8 foot	96 3/8 (2448)	53 1/8 (1349)	44 (1117)
12 foot	144 1/2 (3670)	53 1/8 (1349)	44 (1117)

Note: Each end and insulated partition adds 1 1/2" (38 mm) to the length of the lineup.

Note: Please use Husmann's technical data sheets to get precise dimensions for all store layout purposes.

Web Site: www.husmann.com
E-mail: husmann-marketing@irco.com

Convenient Stocking

The D5XRRRI provides the unique benefit of being stocked from the rear using roll-in milk racks. The case is attached to a walk-in cooler, so the milk doesn't leave its refrigerated environment during stocking. Curtains are used behind the milk to reduce air currents and shield the walk-in storage from view.



Rear of case with curtains

Framed and Suspended Models

The D5XRRRI has the coil and fan mounted in the top section, which is supported with an open frame. In the D5XRRIS, the top section is suspended from above, so frame supports are not needed.

Integrated Night Curtains

Integrated night curtains are optionally available to help reduce energy costs.

Lower Labor Costs

Rear roll-in loading reduces stocking time and frees employees for other tasks.

Note: These merchandisers are designed for use in stores when temperature and humidity do not exceed 75°F and 55% RH.

Note: We reserve the right to change or revise specifications and product design in connection with any feature of our products. Such changes do not entitle the buyer to corresponding changes, improvements, additions or replacements for equipment previously sold or shipped.



Husmann Corporation
12999 St. Charles Rock Rd.
Bridgeton, MO 63044-2483
(314) 291-2000
(314) 298-4756 Fax